Temescal

The Temescal study area is located in the hills within Temescal Valley, approximately 2.5 miles southeast of the City of Corona.

Existing Conditions

General Site Conditions

The study area is located adjacent to Interstate 15, on a ridge with downward slopes to the north, east, and south. The elevation of the study area is approximately 1,064 feet above sea level. The soils present consist of Arbutle gravelly loam and Terrace escarpments, based on the USDA soil survey. Land use in the vicinity consists of Interstate 15 to the east, open space to the south, and open space followed by rural residential development to the north and west. The study area is subject to disturbance associated with off-road vehicles.

Vegetation

The vegetation on the study area consists of a heavily disturbed, non-native grassland. The plant species observed include unidentified, non-native grasses and ruderal species such as short-podded mustard (*Hirschfeldia incana*), and tocalote (*Centaurea melitensis*). The slope to the east of the study area that declines to Interstate 15 contains an small, isolated stand of coastal sage scrub. The plant species observed on the slope include California buckwheat (*Eriogonum fasciculatum*) and deerweed (*Lotus scoparius*).

Wildlife

No wildlife species were observed or otherwise detected during the survey. Wildlife species expected to occur are those commonly found in steep, disturbed, grassland habitats, such as California ground squirrel (*Spermophilus beecheyi*), gopher snake (*Pituophis melanoleucus*), and killdeer (*Charadrius vociferus*).

Sensitive Biological Resources

Sensitive Species

Federally and State Listed Species

Habitat for any State- or federally-listed threatened or endangered species not already covered by an existing HCP does not occur within the study area. Therefore, the development of the study area is not anticipated to impact any plant or animal species protected under CESA or FESA.

WRMSHCP

The study area is located within an area identified by the WRMSHCP as requiring a habitat assessment for San Diego ambrosia (*Ambrosia pumila*), a federally-listed endangered species covered by the WRMSHCP, Munz's onion (*Allium munzii*), a federally-listed endangered and State-listed threatened species covered by the WRMSHCP, spreading navarretia (*Navarretia fossalis*), a federally-listed threatened species covered by the WRMSHCP, burrowing owl (*Athene cunicularia*), a

CSC covered by the WRMSHCP, thread-leaved brodiaea (*Brodiaea filifolia*), Davidson's saltscale (*Atriplex serenana* var. *davidsonii*), Parish's brittle scale (*Atriplex parishii*), smooth tarplant (*Centromadia pungens* ssp. *laevis*), round-leaved filaree (*California macrophylla*), Coulter's goldfields (*Lasthenia glabrata* ssp. *coulteri*), little mousetail (*Myosurus minimus apus*), slender-horned spineflower (*Dodecahema leptoceras*), many-stemmed dudleya (*Dudleya multicaulis*), California orcutt grass (*Orcuttia californica*), San Miguel savory (*Satureja chandleri*), Hammitt's clay-cress (*Sibaropsis hammittii*), and Wright's trichocoronis (*Trichocoronis wrightii wrightii*), all CNPS listed species covered by the WRMSHCP. None of the species were observed within the study area. Suitable habitat for San Diego ambrosia and San Miguel savory was observed on the study area and focused surveys are necessary to determine the occupation status of the species onsite. However, no suitable habitat for any of the remaining species was observed on or adjacent to the study area and no impacts to the species are anticipated.

The study area also contains suitable habitat for California horned lark (*Eremophila alpestris actia*), San Diego black-tailed jackrabbit (*Lepus californicus bennettii*), both CSC covered by the WRMSHCP, Hall's monardella (*Monardella macrantha* ssp. *hallii*), intermediate mariposa-lily (*Calochortus weedii* var. *intermedius*) and Payson's jewel-flower (*Caulanthus simulans*), all CNPS listed species covered by the WRMSHCP. None of these species were observed within the study area. Impacts to these species' habitat have been adequately accounted for by the WRMSHCP and if the development of the study area is found consistent with the WRMSHCP, then further consideration of potential impacts will not be necessary. California horned lark, however, is also protected under the MBTA and CDFG code and impacts to its nesting activities will still need to be avoided.

The study area also contains suitable habitat for Stephens' kangaroo rat (*Dipodomys stephensi*), a federally-listed endangered and State-listed threatened species. The species was not observed within the study area. Impacts to Stephens' kangaroo rat habitat that are anticipated to occur outside of the SKRHCP boundaries, but inside the boundaries of the WRMSHCP have been adequately accounted for by the WRMSHCP and if the development of the study area is found consistent with the WRMSHCP, then further consideration of potential impacts will not be necessary.

Other Sensitive Species

No suitable habitat for sensitive species not specifically protected under any other policy occurs on the study area.

Critical Habitat

The study area is not located within any USFWS-designated Critical Habitat.

Nesting Birds

No nests or nesting activities were observed during the survey; however, the vegetation in the study area contains suitable nesting habitat for ground nesting avian species, such as killdeer.

California Desert Native Plant Act

No plant species protected under the CDNPA were observed within the study area and no impacts associated with the development of the study area are anticipated to occur.

Jurisdictional Waters

No drainage features, wetlands, vernal pools, or suitable habitat for sensitive fairy shrimp species occur on or in the vicinity of the study area. No waters or wetlands potentially under the jurisdiction of the State or the United States will be impacted by the development of the study area.

Wildlife Corridors and Movement

Given the limited size and minimal disturbance associated with the development of the study area, no impacts to any wildlife corridors or wildlife movement patterns are anticipated.

Applicable HCP or Land Use Management Plan

The study area is owned and managed by the Corona-Norco Unified School District (CNUSD) and is subject to the WRMSHCP. The study area is located within the “Temescal” Area Plan, SU3 - Temescal Wash West sub-unit, and falls within Criteria Cell 3035. Development of the study area also has potential to impact urban/wildland interface areas, and will not impact any riparian/riverine areas, as identified by the WRMSHCP.



Source: Riverside County NAIP, 2005.



Michael Brandman Associates

27490003 • 04/2008 | temescal_aerial.mxd

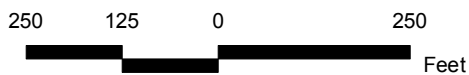

Temescal Communication Site Local Vicinity Aerial Map

COUNTY OF RIVERSIDE
PUBLIC SAFETY ENTERPRISE COMMUNICATION PROJECT

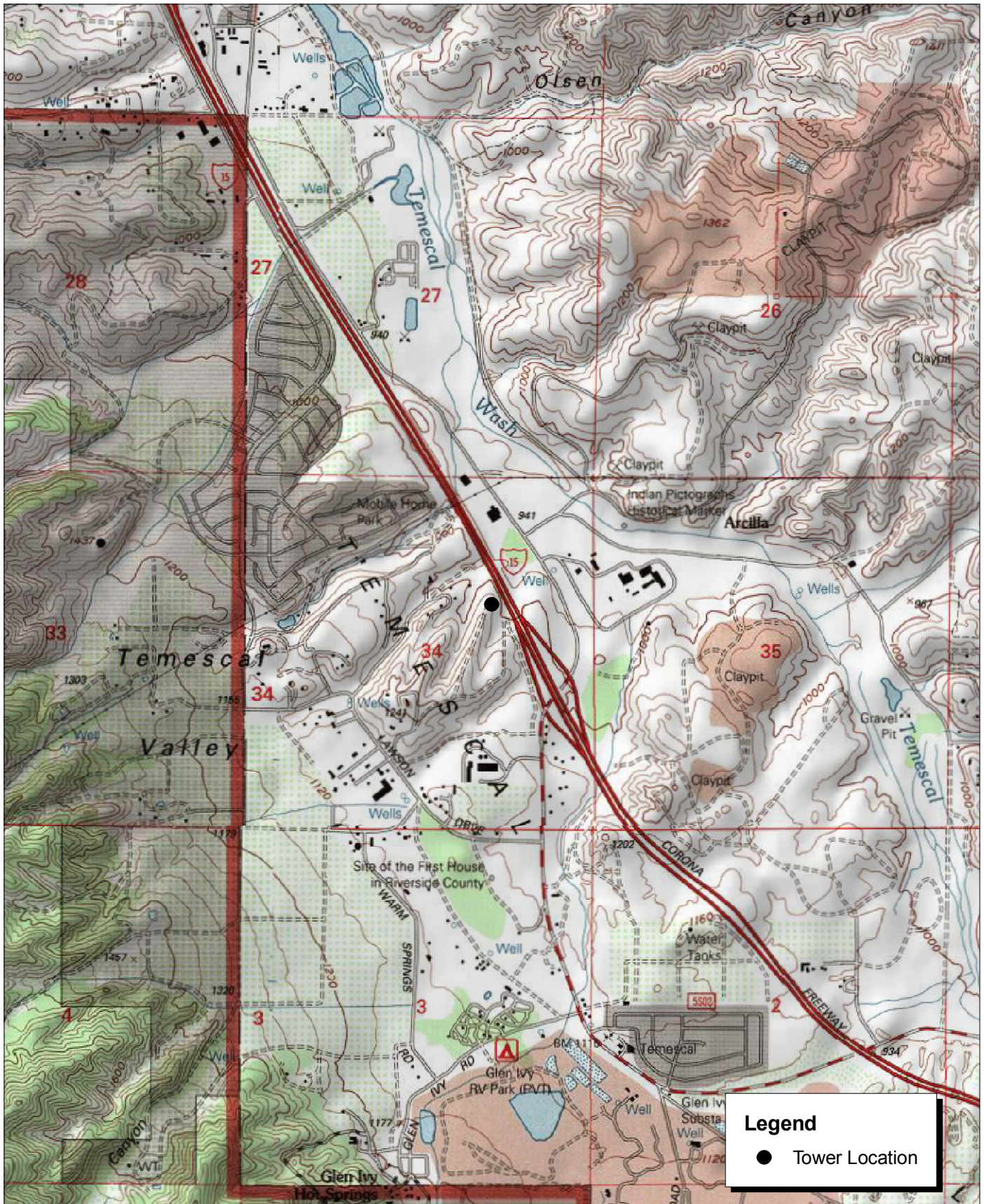

Source: USGS Lake Mathews 7.5' Topographic Map.



Temescal Communication Site Local Vicinity Topographic Map



Source: USDA Soils Data (NRCS).



Temescal Communication Site USDA Soils Map



Photograph 1: View toward Temescal candidate location, facing southeast.



Photograph 2: View toward Temescal candidate location, facing northeast.



Photograph 3: View toward Temescal candidate location, facing northwest.

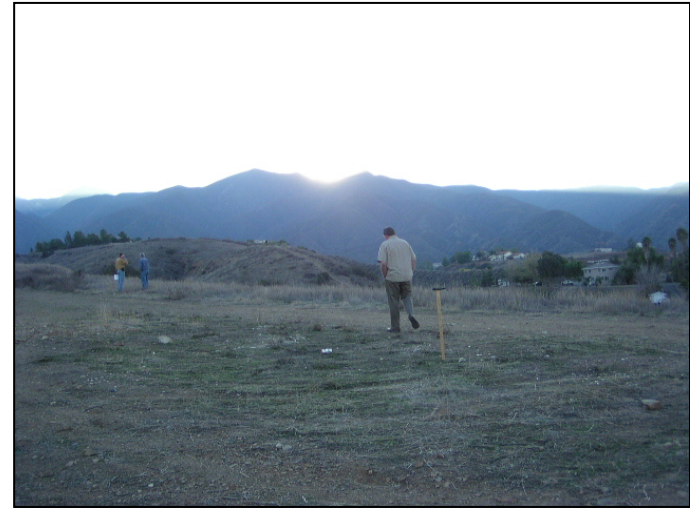

Photograph 4: View toward Temescal candidate location, facing west.

Source: Michael Brandman Associates, 2008.



Michael Brandman Associates

27490003 • 02/2008 | Temescal_Photo1.doc

Temescal Candidate Photographs 1 to 4
PSEC Project



Photograph 5: View from Temescal candidate location, facing east.



Photograph 6: View from Temescal candidate location, facing south.



Photograph 7: View from Temescal candidate location, facing west.



Photograph 8: View from Temescal candidate location, facing north.

Source: Michael Brandman Associates, 2008.



Michael Brandman Associates

27490003 • 02/2008 | Temescal_Photo2.doc

Temescal Candidate Photographs 5 to 8
PSEC Project

Temescal

Western Riverside County Multiple Species Habitat Conservation Plan (MSHCP)

APN	Cell	Cell Group	Acres	Area Plan	Sub Unit
283150017	3035	F	10.57	Temescal Canyon	SU3 - Temescal Wash West

HABITAT ASSESSMENTS

Habitat assessment shall be required and should address at a minimum potential habitat for the following species:

APN	Amphibia Species	Burrowing Owl	Criteria Area Species	Mammalian Species	Narrow Endemic Plant Species	Special Linkage Area
283150017	NO	YES	YES	NO	YES	NO

Burrowing Owl

Burrowing owl.

Criteria Area Species

1) Thread-leaved brodiaea, Davidson's saltscale, Parish's brittlescale, Smooth Tarplant, Round-leaved filaree, Coulter's goldfields, Little Mousetail

Narrow Endemic Plant Species

1) Munz's onion, San Diego ambrosia, Slender-Horned Spineflower, Many-stemmed dudleya, Spreading navarretia, California Orcutt grass, San Miguel savory, Hammitt's clay-cress, Wright's trichocoronis.

If potential habitat for these species is determined to be located on the property, focused surveys may be required during the appropriate season.

Background

The final MSHCP was approved by the County Board of Supervisors on June 17, 2003. The federal and state permits were issued on June 22, 2004 and implementation of the MSHCP began on June 23, 2004.

For more information concerning the MSHCP, contact your local city or the County of Riverside for the unincorporated areas. Additionally, the Western Riverside County Regional Conservation Authority (RCA), which oversees all the cities and County implementation of the MSHCP, can be reached at:

Western Riverside County Regional Conservation Authority
4080 Lemon Street, 12th Floor
Riverside, CA 92502-1604

Phone: 951-955-9700

Fax: 951-955-8873

www.wrc-rca.org