

Brookside Communication Site

Overview

The site is located within an existing County of Riverside Transportation and Land Management Agency (TLMA) maintenance facility situated at the northwest corner of Brookside Avenue and Hannon Road in the community of Cherry Valley. The proposed project will place a tower and equipment shelter at the site.

Table 1: Brookside Communication Site

Latitude ¹	Longitude ¹	Elev ²	Address	T/R/S ³	APN ⁴	USGS Quadrangle
33°57'48.7"	117°00'20.9"	2,584	10875 Hannon Road, Beaumont, CA 92223	2S 1W Sec. 29	407-170-010	El Casco
1 – All coordinates utilize NAD83 datum 2 – All elevations in feet above mean sea level 3 – Township/Range/Section (San Bernardino Base Meridian)				4 – All Assessors Parcel Numbers are located in Riverside County, unless noted: OC = Orange County; SD = San Diego County; SB = San Bernardino County		

Surrounding Land Uses

The site is located within an existing County of Riverside TLMA maintenance facility at the northwest corner of Brookside Avenue and Hannon Road in the community of Cherry Valley. The compound is used to house trucks and heavy equipment, as well as store sand, gravel, asphalt, and other materials. The surrounding areas to the north, west, and east are semirural in nature, with scattered residences and inactive agricultural operations. Hannon Road lies immediately to the east of the site. South of the project site, the TLMA facility is composed of maintenance garages, an office, and a vehicle fueling facility. South of the TLMA compound lies Brookside Avenue, with medium density residential development lying south of the roadway.

Topography and Vegetation

The area is largely flat, former agricultural land. The site itself is a dirt lot that is devoid of vegetation. Surrounding areas are largely inactive farmlands, with non-native grasses comprising the dominant vegetation.

Land Ownership and Applicable Habitat/Land Management Plan

The site is located on land owned and operated by the County of Riverside and is subject to the WRMSHCP. The site is located within “The Pass” Area Plan of the WRMSHCP, but does not fall within a Criteria Cell.

Road Access

The site is essentially a large parking area and storage yard and access is available directly to the site.

Commercial Power Access

Commercial power is already available at the TLMA site and directly across Hannon Road.

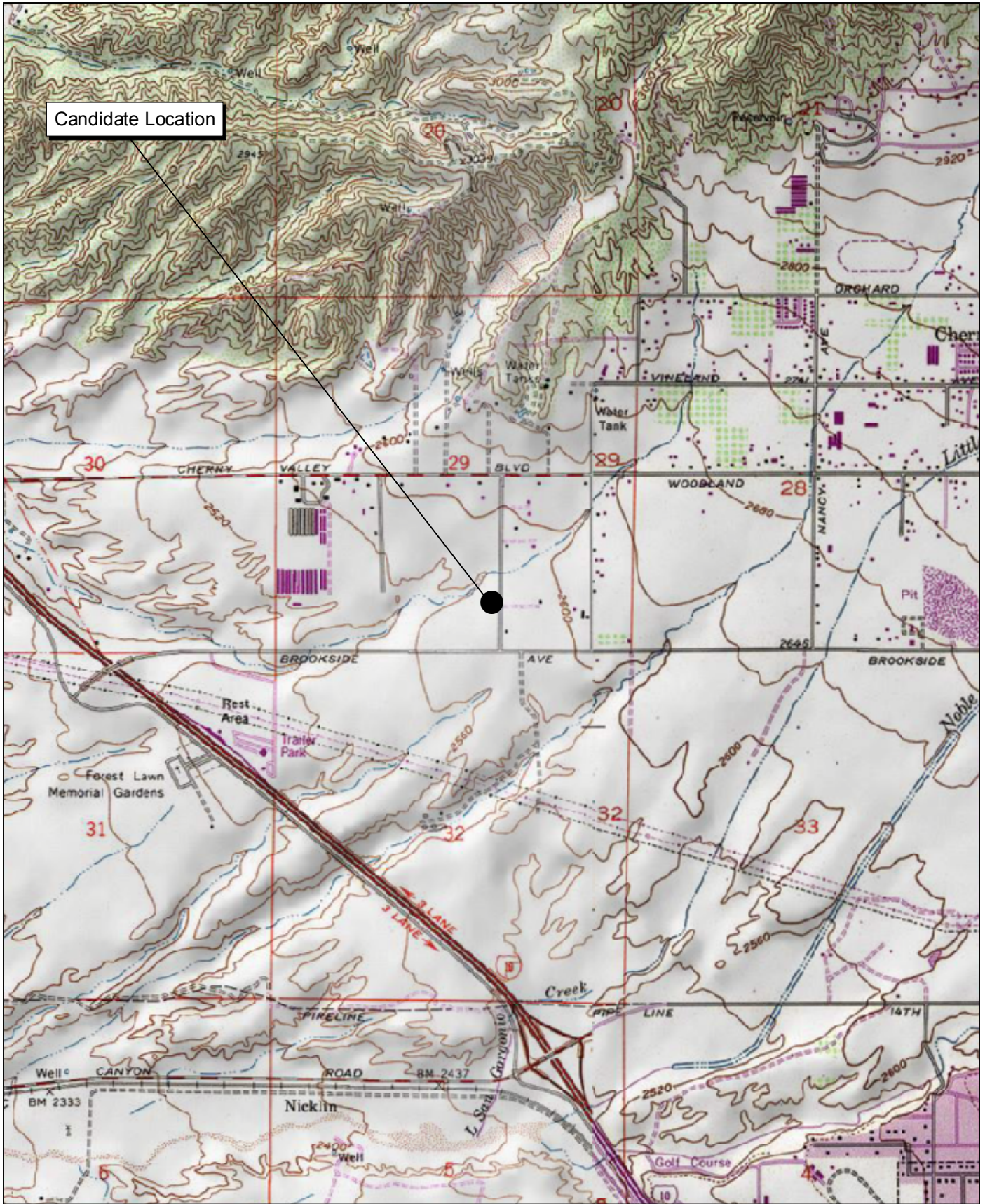

Source: USGS El Casco 7.5' Topographic Map.



Michael Brandman Associates
 27490003 • 04/2008 | brookside.mxd

Brookside Communication Site Local Vicinity Topographic Map

COUNTY OF RIVERSIDE
 PUBLIC SAFETY ENTERPRISE COMMUNICATION PROJECT



Legend

- Candidate Location

Source: Riverside County NAIP, 2005.

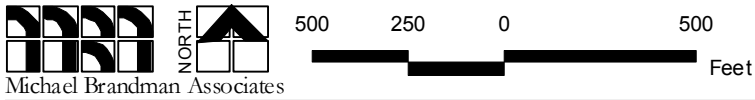

**Brookside Communication Site
 Local Vicinity Aerial Map**



Photograph 1: View toward Brookside candidate location, facing east.



Photograph 2: View toward Brookside candidate location, facing west.



Photograph 3: View toward Brookside candidate location, facing northwest.



Photograph 4: View toward Brookside candidate location, facing south.

Source: Michael Brandman Associates, 2008.





Photograph 5: View from Brookside candidate location, facing northeast.



Photograph 6: View from Brookside candidate location, facing northwest.



Photograph 7: View from Brookside candidate location, facing southwest.



Photograph 8: View from Brookside candidate location, facing southeast.

Source: Michael Brandman Associates, 2008.



Michael Brandman Associates

27490003 • 02/2008 | Brookside_Photo2.doc

Brookside Candidate Photographs 5 to 8
PSEC Project